

balterley

Longnor 1200mm Framed Design Floor Standing 4 Drawer Vanity, Marble Worktop - Coastal Grey

PRODUCT REFERENCE

SKU	BFLL2333CMT2
EAN	5056883709320
Brand	Balterley

PRODUCT DIMENSIONS

Product	818 x 1210 x 460mm (H x W x D)
Packaged	840 x 1220 x 480mm (H x W x D)
Nett Weight	103.5 kg
Packaged Weight	104 kg

PRODUCT DETAILS

Country of Origin	China
Product Material	Mfc Smooth Matt,Natural Marble
Colour/Finish	Coastal Grey
Mount Type	Floor
Style	Contemporary
Handle Type	D Shape
Fixings Included	Yes
Construction Method	Cam & Wood Dowel
Construction Type	Rigid
Drawer Type	80mm High Metal S/C Inc Gallery
Fsc Certified	Yes
Handles Included	Yes
Material Thickness	18 mm
No. Doors	4
No. Drawers	4
Waste Shroud	No

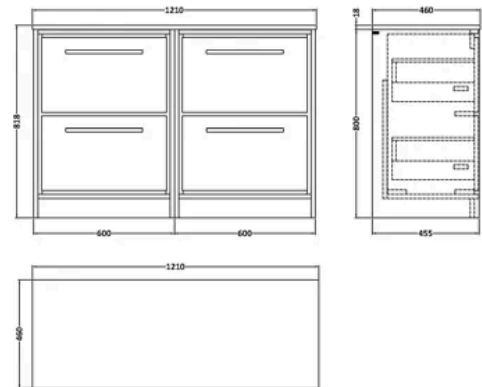

balterley

Hudson Reed 1210x460mm Carrera Marble Worktop

PRODUCT DIMENSIONS

Product	14 x 1210 x 460mm (H x W x D)
Packaged	35 x 1250 x 500mm (H x W x D)
Nett Weight	25.5 kg
Packaged Weight	26 kg

PACKAGING DETAILS

Label Size (mm)	50 x 100
Label Colour	White
Label Qty	1.0000

PRODUCT DETAILS

Country of Origin	China
Product Material	Natural Marble
Colour/Finish	White
Style	Contemporary
Fixings Included	No
Fsc Certified	Yes
Material Thickness	14 mm

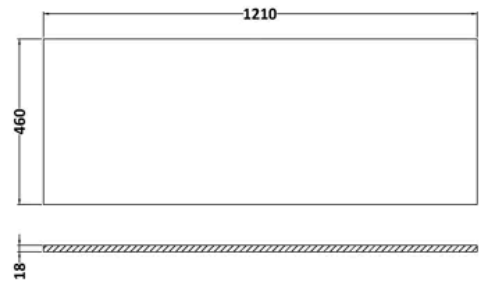

Lille 600mm Coastal Grey 2 Drawer Floor Standing Vanity Unit

PRODUCT DIMENSIONS

Product	800 x 600 x 455mm (H x W x D)
Packaged	840 x 632 x 480mm (H x W x D)
Nett Weight	38.5 kg
Packaged Weight	39 kg

PACKAGING DETAILS

Label Colour	White
Label Qty	2.0000

PRODUCT DETAILS

Country of Origin	China
Product Material	Mfc Smooth Matt
Colour/Finish	Coastal Grey
Mount Type	Wall Hung
Style	Contemporary
Handle Type	D Shape
Fixings Included	Yes
Construction Method	Cam & Wood Dowel
Construction Type	Rigid
Drawer Type	80mm High Metal S/C Inc Gallery
Fsc Certified	Yes
Handles Included	Yes
Material Thickness	18 mm
No. Drawers	2
Waste Shroud	No

